

REV	REVISION NOTE	DATE	BY
1	INITIAL RELEASE	01/19/2010	C.H.PARK
2	TOLERANCE CHANGED	01/15/2013	D.H.YOO

① GAIN BASE

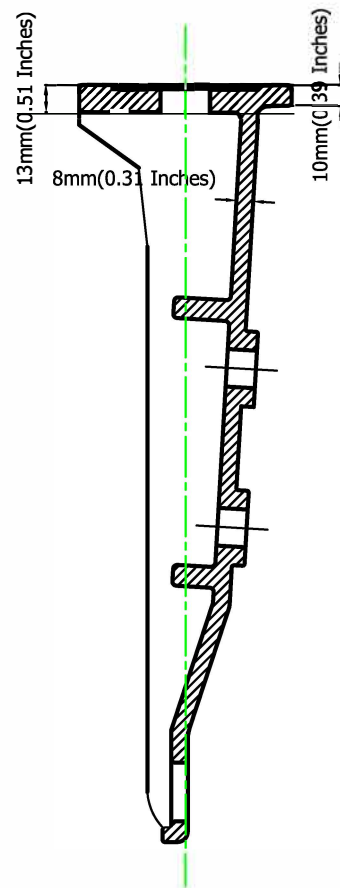

SECTION A-A'

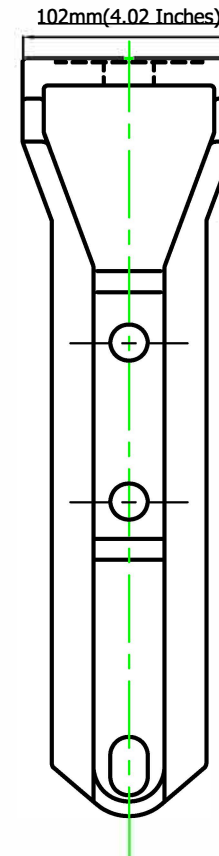
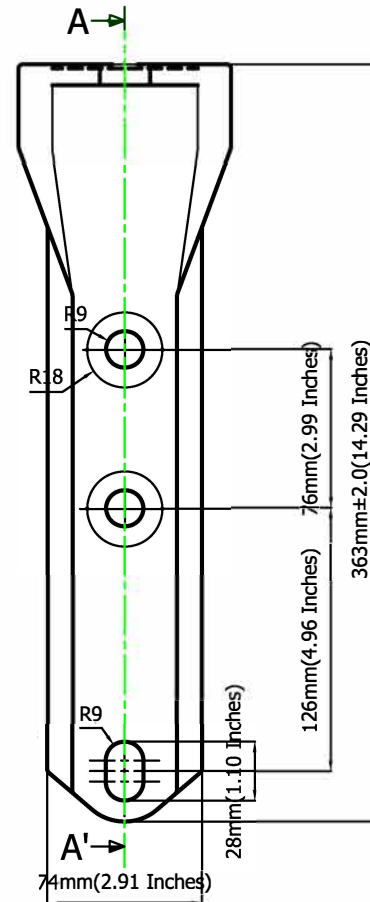
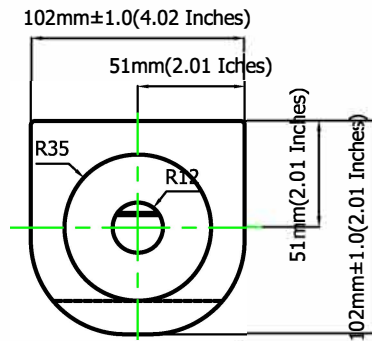

② 7/8" BOLT SET

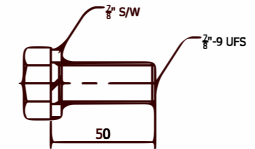

NOTE:

1. GAIN BASE ARE MADE FROM SPHEROIDAL GRAPHITE CAST IRON.
2. STUD BOLT ARE MADE FROM SS41.
3. THE TOLERANCE ON DIMENSIONS IS NOT EXCEED 2%.
4. PLEASE NOTE ON THE DRAWING THAT THIS 7/8" BOLT & WASHER IS USED FOR 46-69KV LINE POST INSULATOR.

THESE DRAWINGS AND SPECIFICATIONS, AND THE DATA CONTAINED THEREIN ARE THE EXCLUSIVE PROPERTY OF TYP TECHNOLOGIES INC. THESE DRAWINGS ARE ISSUED IN STRICT CONFIDENCE AND SHALL NOT, WITHOUT THE PRIOR WRITTEN PERMISSION OF TYP TECHNOLOGIES INC., BE REPRODUCED, COPIED, OR USED FOR ANY PURPOSE WHATSOEVER, EXCEPT THE MANUFACTURE OF ARTICLES FOR TYP TECHNOLOGIES INC.

DIMENSIONAL TOLERANCES UNLESS OTHERWISE NOTED
 X ± 0.1
 XX ± 0.02
 XXX ± 0.010
 ANGLES $\pm 1^\circ$

Designed by
C.H.PARK



Date
01/15/13

Part Number
ARP-GBV-2

Scale
N/A

GAIN BASE FOR VERTICAL TYPE

Filepath

Units
INCHES

Sheet
1/1