

Catalog Number	Voltage class	'X' Section Length inch (mm)	Base Fitting Thread (in)	No. of Sheds	Leakage Distance inch (mm)	Dry Arc Distance inch (mm)	SCL Specified Cantilever Load lbs (kN)	Max Design Cantilever Load lbs (kN)	Tensile Strength lbs (kN)	PFFO Dry (kV)	PFFO Wet (kV)	CFO Pos (kV)	CFO Neg (kV)	RIV test (kV)	RIV Max (µV)
Horizontal															
ARP-LPH-15SK	15	10.0 (255)	3/4-10 +.015"	4	12.7 (322)	7.7 (196)	2800 (12.5)	1400 (6.25)	5,000 (22)	86	66	146	193	10	100
ARP-LPH-25SK	25	14.5 (369)	3/4-10 +.015"	5	20.3 (516)	12.3 (312)	2800 (12.5)	1400 (6.25)	5,000 (22)	122	103	208	271	15	100
ARP-LPH-35SK	35	16.8 (427)	3/4-10 +.015"	7	24.1 (613)	14.6 (370)	2800 (12.5)	1400 (6.25)	5,000 (22)	141	122	239	309	22	100
ARP-LPH-35SK-HP	35	18.1 (460)	7/8-9 +.015"	7	42.9 (1090)	12.0 (306)	2800 (12.5)	1400 (6.25)	5,000 (22)	135	107	196	218	22	100
ARP-LPH-46SK	46	25.6 (651)	7/8-9 +.015"	7	47.0 (1195)	19.2 (487)	2800 (12.5)	1400 (6.25)	5,000 (22)	188	168	310	376	30	200
ARP-LPH-69SK-HP	69	28.1 (714)	7/8-9 +.015"	8	54.6 (1387)	21.6 (550)	2800 (12.5)	1400 (6.25)	5,000 (22)	230	200	380	470	44	200
ARP-LPH-69SK-HP	69	28.1 (715)	7/8-9 +.015"	15	91.7 (2330)	22.0 (560)	2800 (12.5)	1400 (6.25)	5,000 (22)	230	200	380	470	44	200
ARP-GBH-1	Gain base used for 15, 25, 35 kV posts. Includes 3/4" galvanized bolt to mount insulator														
ARP-GBH-2	Gain base used for 35-HP, 46, 69 kV posts. Includes 7/8" galvanized bolt to mount insulator														
Vertical															
ARP-LPV-15SK	15	10.2 (259)	3/4-10 +.015"	4	12.7 (322)	7.7 (196)	2800 (12.5)	1400 (6.25)	5,000 (22)	86	66	146	193	10	100
ARP-LPV-25SK	25	14.7 (373)	3/4-10 +.015"	6	20.3 (516)	12.3 (312)	2800 (12.5)	1400 (6.25)	5,000 (22)	122	103	208	271	15	100
ARP-LPV-35SK	35	17.0 (432)	3/4-10 +.015"	7	24.1 (613)	14.6 (370)	2800 (12.5)	1400 (6.25)	5,000 (22)	141	122	239	309	22	100
ARP-LPV-46SK	46	25.6 (650)	7/8-9 +.015"	7	47 (1195)	19.2 (487)	2800 (12.5)	1400 (6.25)	5,000 (22)	188	168	310	376	30	200
ARP-LPV-69SK	69	28.1 (713)	7/8-9 +.015"	8	54.6 (1387)	21.7 (550)	2800 (12.5)	1400 (6.25)	5,000 (22)	230	200	380	470	44	200
ARP-LPV-69SK-HP	69	28.1 (713)	7/8-9 +.015"	15	91.7 (2330)	22.1 (560)	2800 (12.5)	1400 (6.25)	5,000 (22)	230	200	380	470	44	200
ARP-GBV-1	Gain base used for 15, 25, 35 kV posts. Includes 3/4" galvanized bolt to mount insulator														
ARP-GBV-2	Gain base used for 46, 69 kV posts. Includes 7/8" galvanized bolt to mount insulator														

LINE POSTS

example: ARP-LPH-15SKGB-1

Brand	Insulator type	End Fittings	Voltage	Material & Mfg location	Options
ARP	LP	H	15	SK	GB-1
ARP= Advanced Rubber Products	LP= Line post	H= Horizontal V= Vertical CN= 'C' neck FN- 'F' neck SC= Integral clamp	15= 15kV 25= 25kV 35= 35kV 46= 46kV 69= 69kV	SK= Silicone	Blank= No options GB= Gain base (hor or vert) HP= High leak SP= Special design 1= Includes cable clamp 34= 3/4" +.015" tapped hole GB-1= Gain base and cable clamp

NOTE:

1. End Fittings are made from Galvanized Forged Steel.
2. Fiberglass solid core rod is made using Epoxy Resin.
3. Clamp and Stud Base dimensions are in accordance with ANSI C29.7.
4. 15, 25, & 35KV Insulators - 3/4-10 UNC Galvanized Bolt supplied with Gain Base.
5. 46 & 69KV Insulators - 7/8-10 UNC Galvanized Bolt supplied with Gain Base.

ADVANCED RUBBER PRODUCTS

Silicone Polymer Horizontal & Vertical Line Post Insulators 15KV, 25KV, 35KV, 46KV, & 69KV

Imagination fused with high technologies

ISO 9001:2015
BUREAU VERITAS
Certification



**ANSI DESIGNS
RUS APPROVED**



ARPTM
Advanced Rubber Products
Div. of TMP Technologies Inc.

6110 Lamb Road • Wyoming, NY 14591
Phone: 585.495.6231 • Fax: 585.495.6526

www.arp-hivoltageinsulators.com
email: techsales@advancedrubberproducts.com

Silicone Polymer Horizontal Line Post Insulators

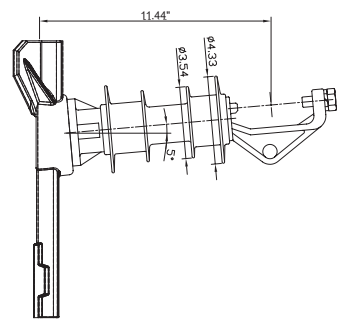

ARP-LPH-15SKGB

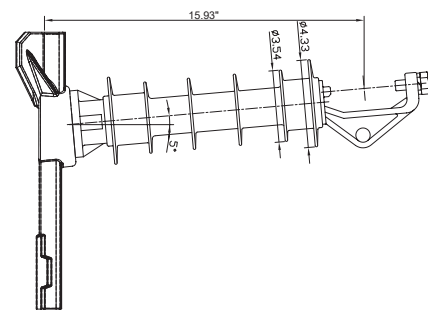

ARP-LPH-25SKGB

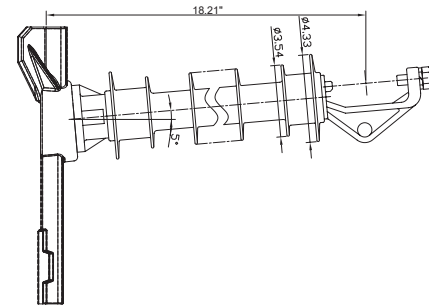

ARP-LPH-35SKGB

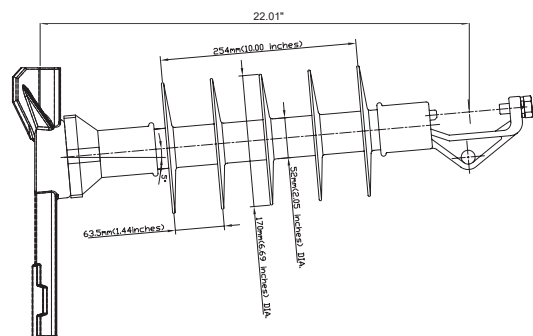

ARP-LPH-35SKHPGB

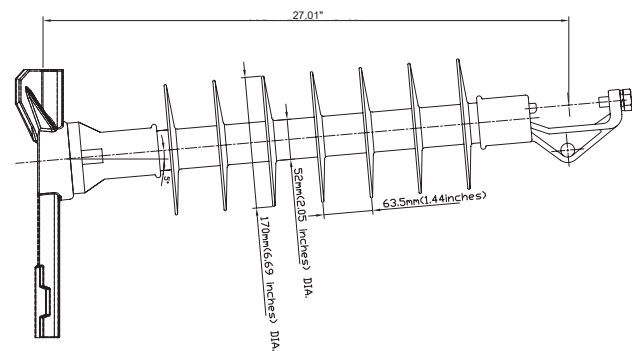

ARP-LPH-46SKGB

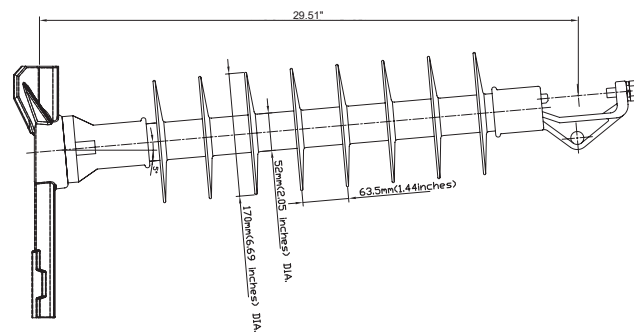

ARP-LPH-69SKGB

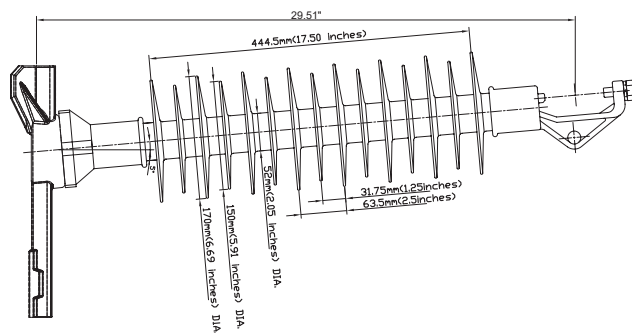

ARP-LPH-69SKHPGB

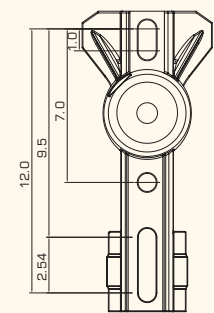

GAIN BASE ARP-GBH

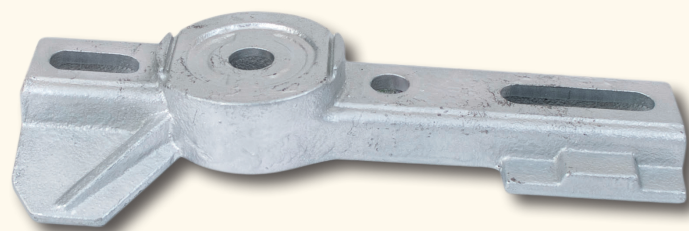

ARP-GBH-1 = 3/4" Bolt
ARP-GBH-2 = 7/8" Bolt

ARP Horizontal Gain Base is inter-changeable with most other industry bases and can be mounted to existing 6" center to center pole mounting holes.

Silicone Polymer Vertical Line Post Insulators

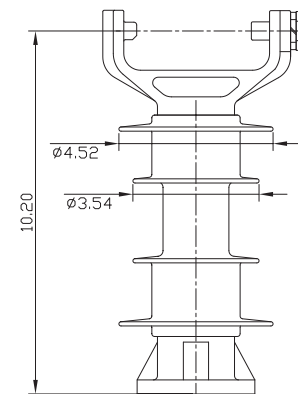

ARP-LPV-15SK

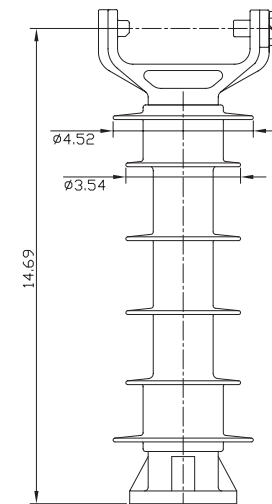

ARP-LPV-25SK

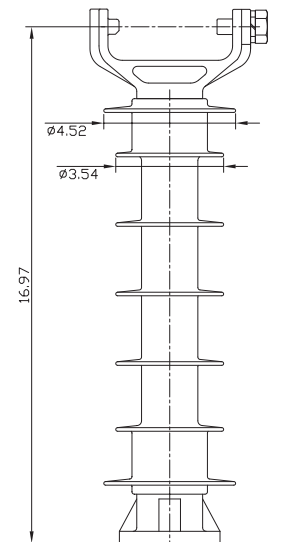

ARP-LPV-35SK

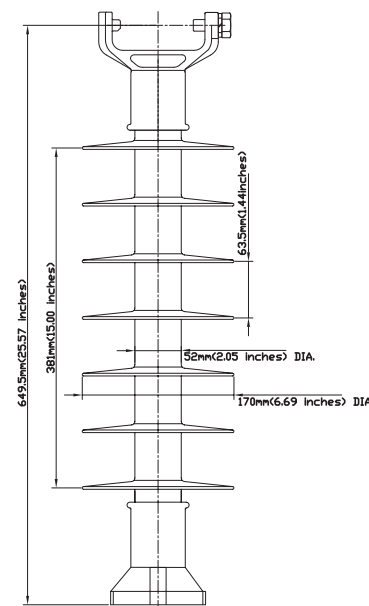

ARP-LPV-46SK

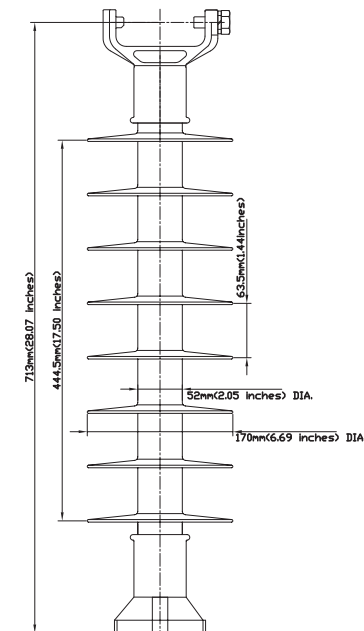

ARP-LPV-69SK

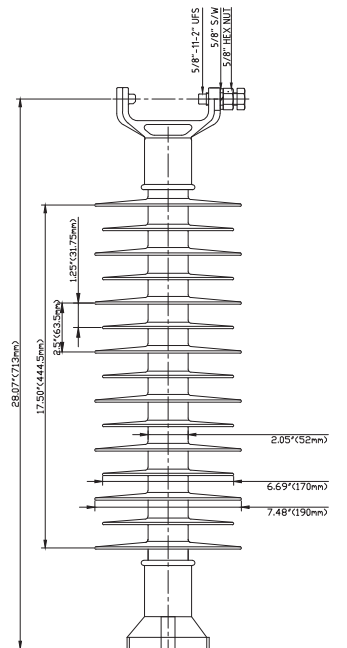

ARP-LPV-69SK-HP

CABLE CLAMP

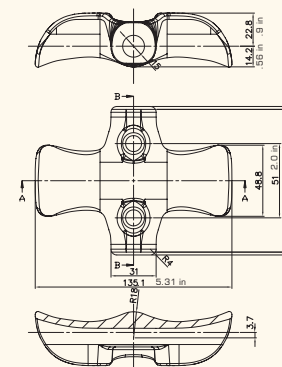
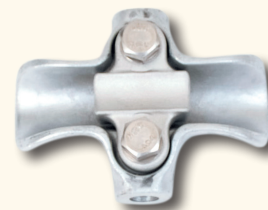

PART NUMBER	CONDUCTOR RANGE	
	MIN	MAX
ARP-ATC-150	.375"	1.06"

GAIN BASE ARP-GBV

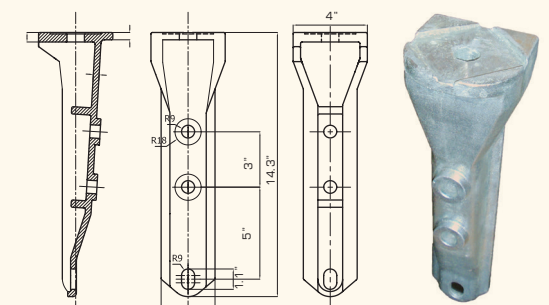

ARP-GBV-1 = 3/4" Bolt ARP-GBV-2 = 7/8" Bolt